

2 ROOF PLAN / DRAFTSTOP BLDG #2  
A-1 DRAFT STOPPING TO BE INSTALLED AT TENANT SEPARATION WALLS 1/8"=1'-0"

INDICATES ATTIC DRAFT STOP  
LABEL WALLS AS DRAFT STOP AND INSTALL DOORS  
THAT ARE SELF CLOSING.

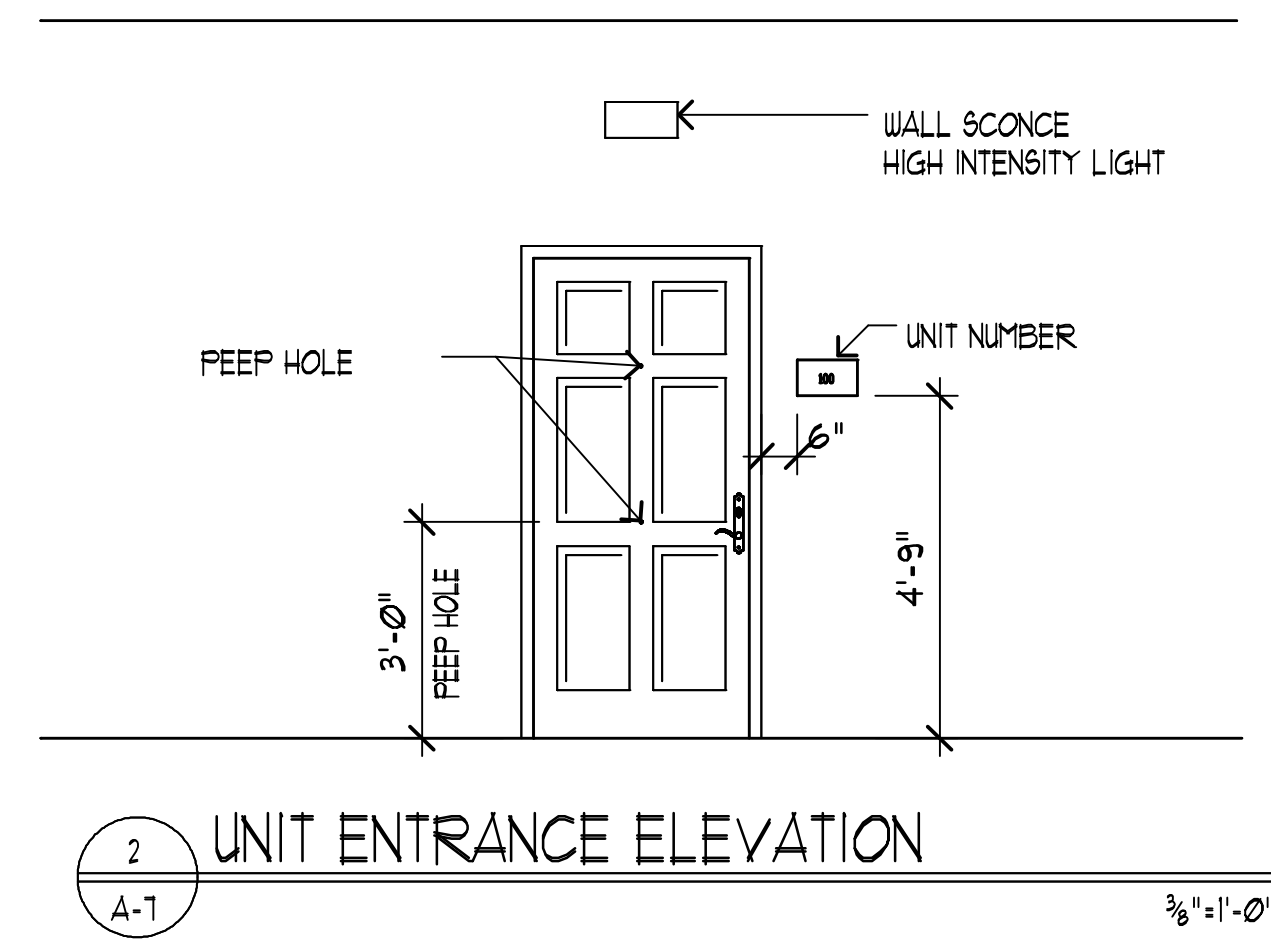

2 UNIT ENTRANCE ELEVATION  
A-1 3/8"=1'-0"

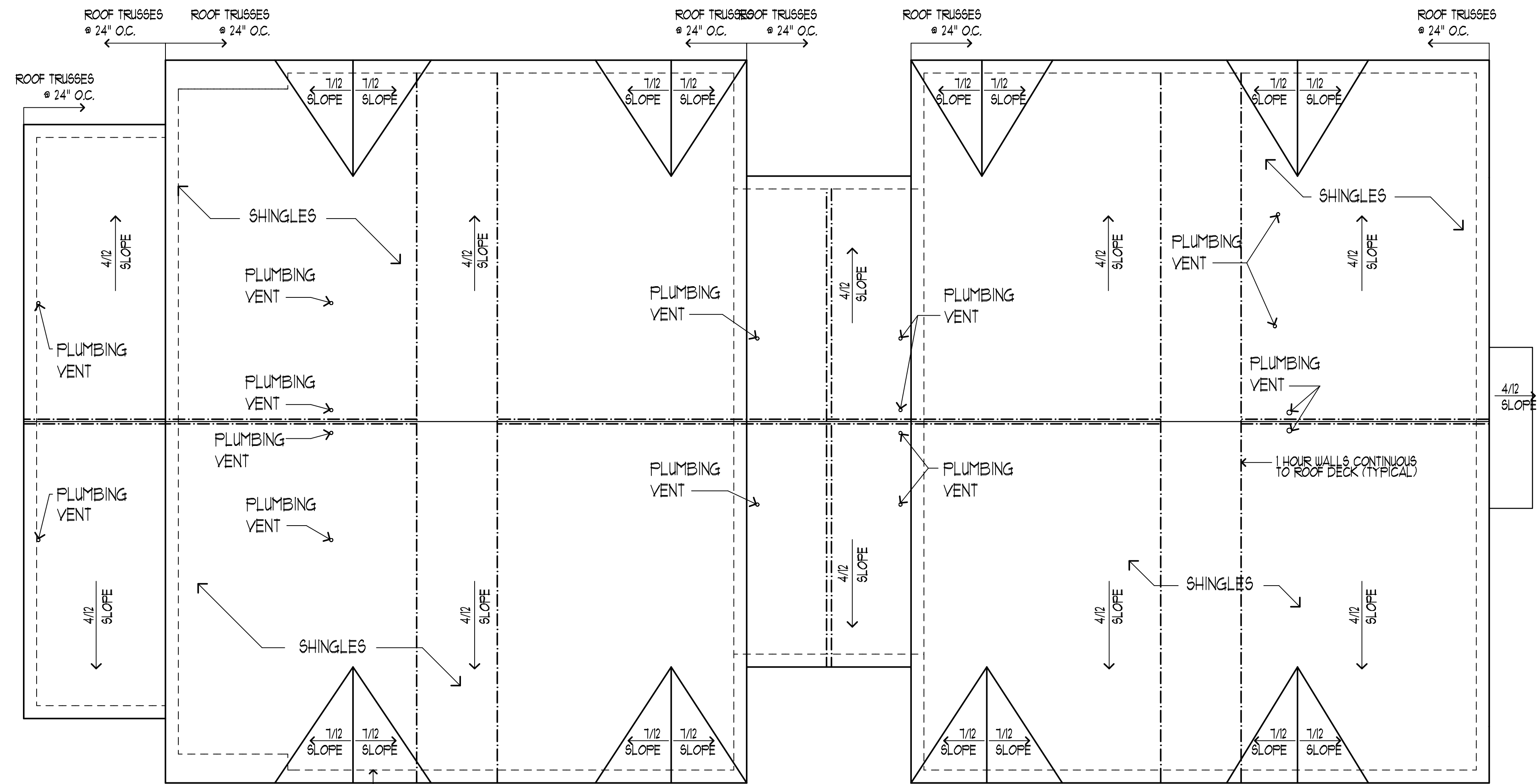

1 ROOF PLAN / DRAFTSTOP BLDG #1  
A-1 DRAFT STOPPING TO BE INSTALLED AT TENANT SEPARATION WALLS 1/8"=1'-0"

INDICATES ATTIC DRAFT STOP  
LABEL WALLS AS DRAFT STOP AND INSTALL DOORS  
THAT ARE SELF CLOSING. DRAFT STOP 1 HR RATED.

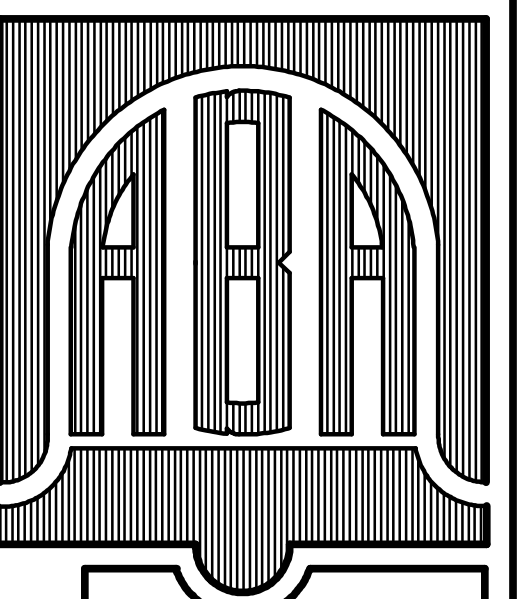

**ALAN BELL ARCHITECT Inc**  
ARCHITECTURE, ENGINEERING, PLANNING  
ASSOCIATES  
MARK SMITH, DOUGLAS ELKINS  
LORI MOON, LARRY TRAN, ADAM LONG  
alanbellarchitect.com  
211 GORDON ST  
BREMEN, GA 770-537-8856  
8 EAST 4TH AVE  
ROME, GA 770-232-2256

REVISIONS	BY

NEW APARTMENTS FOR  
**PIER POINT**  
LINCOLN, ALABAMA

CONTRACTOR SHALL VERIFY ALL CONDITIONS AND DIMENSIONS BEFORE EXECUTING ANY WORK. THIS DOCUMENT IS THE SOLE PROPERTY OF ALAN BELL ARCHITECT AND SHALL NOT BE COPIED IN WHOLE OR IN PART WITHOUT EXPRESSED WRITTEN CONSENT FROM ALAN BELL ARCHITECT.

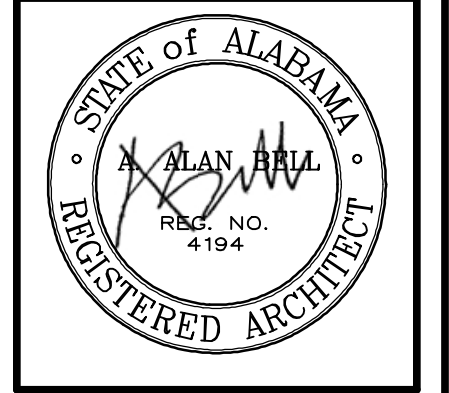

DATE: MARCH 11, 2010  
SCALE: AS NOTED  
JOB NO.: 08034-HII  
SHEET  
A-1  
OF 11 SHEETS